

Lens Accessory Studio Conversion Kit SS-41-IASD

Operation Manual (BT1-B091-B)

- (1) Read "GENERAL SAFETY INFORMATION" (back side) before using the product. The safety cautions must be observed.
- (2) Read operation manual (this sheet) before using the product. Keep the manual in place for future reference.

Thank you for purchasing a studio conversion kit <SS-41-IASD>.

The studio conversion kit <SS-41-IASD> supplies all the accessories necessary to convert cameras mounted with digital drive unit loading lens into "rear view" TV cameras that can be mounted on a tripod.

When using the lens of analog drive unit loading, a conversion cable <ZSD-300D:CC-0820/FPD-400D:CC-0620> is needed separately. In that case, a part of the function is restricted.

1 Product components

Zoom demand (ZSD-300D)

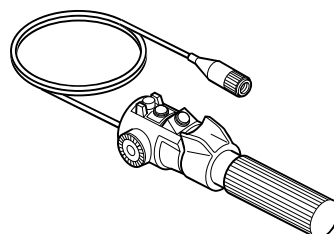

Zoom demand (FPD-400D)

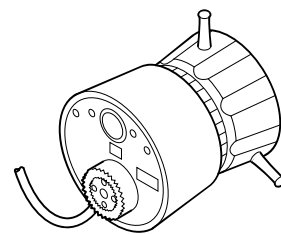

Clamper (CR-10)

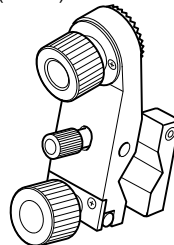

Operation Manual

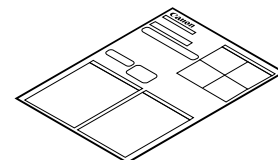

Contact us Please contact us if you have questions on the products.

Canada: Canon Canada, Inc. Broadcast and Communications Div.
Tel:+1(905)795-2012 Fax:+1(905)795-2087

Mexico: Canon Mexicana, S. de R.L. de C.V. Call Center Div.
Tel:+52 55 5249 4905

USA: Canon U.S.A., Inc. ITCG Bus Develop Tech Support Div.
Tel:+1(800) 423-5367 (Toll Free) Fax:+1(201) 807-3344

Hong Kong, S.A.R.: Canon Hongkong Company Ltd. ICP Marketing Div.
Tel:+852-3191-2333

Korea: 캐논코리아 컨슈머 이미징 (주) 제품마케팅팀 프로솔루션파트
대표전화: (82)2-2191-8500 팩스: (82)2-2191-8576

South and Southeast Asia: Canon Singapore Pte. Ltd.
REG ICP Sales & Marketing Center Tel:+65-6799-8888

Europe/Africa/Middle East: Canon Europe Ltd. Broadcast Products Div.
Tel:+44(0)20-8588-8140 Fax:+44(0)20-8588-8929

Canon Europa N.V.
Bovenkerkerweg 59, 1185 XB Amstelveen, The Netherlands

Oceania: Canon Australia Pty. Ltd. CCI Div.
Tel:+61(0)2-9805-2000

2 System configuration

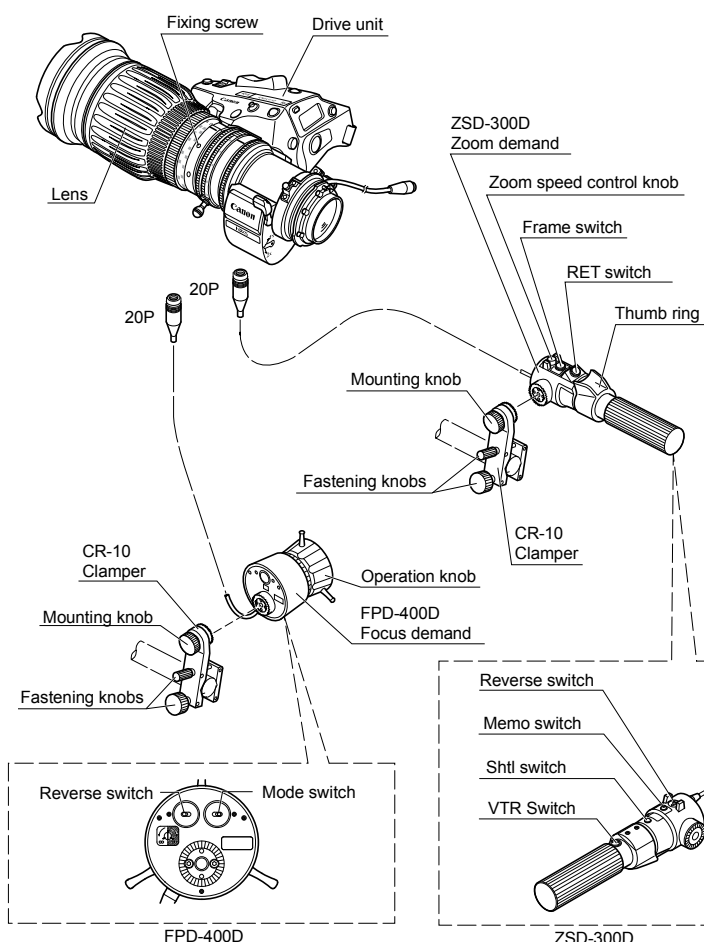

3 Mounting

[Attaching focusing accessories]

1. Loosen the large and small fastening knobs of the clamper provided. Mount this unit onto panning handle of the tripod, and tighten both fastening knobs to secure the clamper.
2. Engage the rose joint of the focus demand and that of the clamper, and then tighten them with the mounting knob.
3. Connect the focus demand cable to the 20-pin connector at the bottom of the lens drive unit. Any of the 20-pin connectors can be connected.
4. Make sure that the focus ring on the lens body rotates by turning the operation knob of the focus demand.

[Attaching zooming accessories]

1. Loosen the large and small fastening knobs of the clamper provided. Mount this unit onto panning handle of the tripod, and tighten both fastening knobs to secure the clamper.
2. Engage the rose joint of the zoom demand and that of the clamper, and then tighten them with the mounting knob.
3. Connect the zoom demand cable to the 20-pin connector at the bottom of the lens drive unit. Any of the 20-pin connectors can be connected.
4. Make sure that the zoom ring on the lens body rotates by turning the thumb ring of the zoom demand.

4 Operation

[Focusing operation]

Set the focus operation change-over knob at the bottom of the lens drive unit to the <SERVO> position. This setting operation can be performed more smoothly if the knob is moved while rotating the focus ring slightly.

1. Basic operation

< Focusing operation / Opeation knob operation >

To focus, rotate the operation knob of the focus demand. By default, as viewed from the grip side,

Right rotation: To maximum object distance

Left rotation : To minimum object distance

< Changing the focusing direction >

The focus direction may be changed by switching the position of the reverse switch.

< Focus characteristics curve selection >

The focus characteristics curve selection switch can be used to select either line or curve modes for the focus movement characteristics.

STANDARD Mode (switch at left side) :

Standard characteristics where the focus lens group moves linearly when the knob is rotated.

FAR Mode (switch at right side) :

Curve characteristics where the focus lens group exhibits less movement as it approaches the FAR end when the knob is rotated. This mode makes it easy to perform fine adjustment at the FAR end.

[Zooming operation]

Set the zoom operation change-over knob at the bottom of the lens drive unit to the <SERVO> position. This setting operation can be performed more smoothly if the thumb ling is moved while rotating the zoom ring slightly.

1. Basic Operation

< Zooming operation / Thumb ring operation >

The zoom function is controlled by turning the thumb ring of the zoom demand. How much the thumb ring is rotated determines the zooming speed. The zooming speed varies according to the rotation angle of thumb ring.

< Adjusting the max. zoom speed. >

The max. zoom speed, obtained by completely turning the thumb ring of the zoom demand, is changeable with the zoom speed control knob.

Turning this knob clockwise, faster speed can be obtained.

Turning this knob counterclockwise, lower speed can be obtained.

< To change the zooming direction >

The thumb ring of the zoom demand is factory set to zoom in (telephoto), when it is pressed toward the right.

However, this zoom direction can be changed by switching the position of the reverse switch.

2. Applied operations

Function 1 : Shuttle shot

This comes in handy for shots involving frequent switching between two picture angles.

Function 2 : Framing preset

This makes it easy to reproduce a preset picture angle and zoom speed during a rehearsal, etc.

Function 3 : Speed preset

This presets the zoom speed during a rehearsal, etc. and enables the preset speed to be reproduced repeatedly.

The Shtl switch, Frame switch and Memo switch as well as the VTR switch and RET switch on the zoom demand which are used for these operations correspond to their counterparts on the lens unit. However, the DIP switches on the lens unit which are used to perform various settings must be set to their proper positions. For further details on operation and functions, refer to the lens operation manual.

RET switch and VTR switch

One RET switch and one VTR switch are installed on the zoom demand. These switches are equivalent to those on the lens drive unit. While the RET switch is held down, on air picture/being recorded picture can be seen in the viewfinder through camera control system when multi cameras are connected to its system. Press VTR switch to execute the operation of VTR and press again to stop the operation of VTR.



GENERAL SAFETY INFORMATION

The safety warnings and cautions provided on the product or in this operation manual must be observed. Failure to observe these warnings and cautions provided to guard against hazards may result in injury or accident. Read this operation manual carefully to familiarize yourself with its contents and ensure that you can operate the product properly. Also, keep this manual in a safe place where it can easily be referenced whenever required.

This manual uses the following symbols and terms in the warning and caution notices for preventing accidents and protecting the safety of the customer and others.

	WARNING	This indicates a potentially hazardous situation which, if not heeded, may result in death or serious injury to you or others. Be sure to heed all warning notices to ensure safe operation at all times.
	CAUTION	This indicates a potentially hazardous situation which, if not heeded, may result in a minor injury to you or others, or damage to property. Be sure to heed all caution notices to ensure safe operation at all times.
	NOTE	This indicates cautions and recommendations for operation. It contains information which, if not heeded, may result in this product failing to function properly. These notices also contain useful information for operation.

WARNING

- Do not get this product wet or allow liquid inside. If water gets inside, stop using the product immediately. Continuing to use the product under this condition may cause a fire or electric shocks.
- Be sure to hold the connector when disconnecting the cable. Pulling on the cable may sever or damage it and pose a risk of a fire or electric shocks from a short circuit.

CAUTION

- Be careful not to drop the product when carrying it. Dropping the product may cause injury.
- Ensure that all mountings are securely tightened. If a mounting becomes loose, parts may fall off and cause injury.
- Inspect mountings regularly (about every six months to one year) to ensure they are securely tightened. If a mounting becomes loose, parts may fall off and cause injury.

NOTE

- Striking or dropping the lens may cause the malfunction of the product.
- This product is not waterproof. Take measures to avoid direct contact with rain, snow, or moisture. Otherwise it may cause the malfunction of the product.
- In dusty environments, cover the product when attaching or removing the product. If dust enters inside, it may cause the malfunction of the product.
- Before use in particular environments, such as places where chemical products are used, contact your Canon representative. Otherwise it may cause the malfunction of the product.

HANDLING THE PRODUCT

WARNING

If any of the following situations occurs, immediately disconnect the power plug from the power outlet and contact Canon's representative or the dealer from whom you purchased the product.

- Smoke, fumes, or unusual noises.
- Entry of foreign objects (such as liquid or metal objects) inside the product

MAINTENANCE AND INSPECTION

WARNING

Be sure to disconnect the cable and remove the lens from the camera before cleaning outside of the lens. Do not use benzene, thinner, or other flammable substances to clean the product. Otherwise it may cause a fire or electric shocks.

NOTE

Routine inspection about once a year is recommended, depending on the conditions and environment of use. Request overhaul, if needed.

STORAGE

NOTE

Immediately wipe off any moisture on the lens from misty or foggy environments, using a dry cloth. Seal the lens in a plastic bag with a desiccant (preferably new) to prevent moisture inside. Otherwise it may cause the mold or the malfunction of the product.

TO THE CUSTOMER

- Canon shall bear no responsibility for damage resulting from improper operation of this product by the customer.
- Canon shall make no guarantees about the product quality, functions, or operation manual and its marketability and suitability for the customer's purpose. Moreover, Canon shall bear no responsibility for any damage, direct or incidental, that results from usage for the customer's purpose.
- Canon shall make no guarantees about the results obtained using this product.
- The product specifications, configuration, and appearance are subject to change without prior notice.
- For further information on repairs, maintenance, or adjustments not mentioned in this operation manual, contact your Canon dealer or your Canon sales representative.
- Note that Canon may be unable to undertake servicing or repair of a product if it is modified without consulting Canon or your Canon sales representative.



We, Canon Inc., in Japan and CANON EUROPE LTD., in U.K., confirm that the BCTV zoom lens is in conformity with the essential requirements of EC Directive(s) by applying the following standards:
EN55032 and EN55103-2

Note:

- Applicable Electromagnetic Environments:
E1 (residential), E2 (commercial and light industrial), E3 (urban outdoors) and E4 (controlled EMC environment, ex. TV studio).
- Use of shielded cable is required to comply with limits specified by above standards.

Dieses Produkt ist zum Gebrauch im Wohnbereich, Geschäfts- und Gewerbebereich sowie in Kleinbetrieben vorgesehen.

Only for European Union and EEA (Norway, Iceland, and Liechtenstein)



This symbol indicates that this product is not to be disposed of with your household waste, according to the WEEE Directive (2012/19/EU) and national legislation. This product should be handed over to a designated collection point, e.g., on an authorized one-for-one basis when you buy a new similar product or to an authorized collection site for recycling waste electrical and electronic equipment (WEEE). Improper handling of this type of waste could have a possible negative impact on the environment and human health due to potentially hazardous substances that are generally associated with WEEE. At the same time, your cooperation in the correct disposal of this product will contribute to the effective usage of natural resources. For more information about where you can drop off your waste equipment for recycling, please contact your local city office, waste authority, approved WEEE scheme or your household waste disposal service.

For more information regarding return and recycling of WEEE products, please visit www.canon-europe.com/wEEE.

CANON INC.

30-2, Shimomaruko 3-chome, Ohta-ku, Tokyo 146-8501, Japan

Canon Europe Ltd

3 The Square, Stockley Park, Uxbridge, Middlesex, UB11 1ET UK

All rights reserved. No part of this operation manual may be reproduced or copied in any form or by any means without the written permission of Canon Inc.