

XT[2]

SD/HD Live/Studio Production & Playout Server

XT[2]

The XT series production servers have been selected by the world's top broadcasters at virtually every major event for capturing live content. The XT[2] platform brings a new generation of EVS' world-class technology into a multi-channel, multi-format, SD/HD video server with such power, it's revolutionizing the broadcast workflow environment.

The XT[2] production server is the new generation platform from EVS. Thanks to its HD architecture and SD compatibility, the XT[2] is perfectly suited to evolving market needs, from SD to HD. It builds on the success of production applications from the world reference XT series: multi-camera recording, slow-motion and super slow-motion replays, on the fly editing, clip-store, play-out, program turnaround, video delay, archiving, etc.

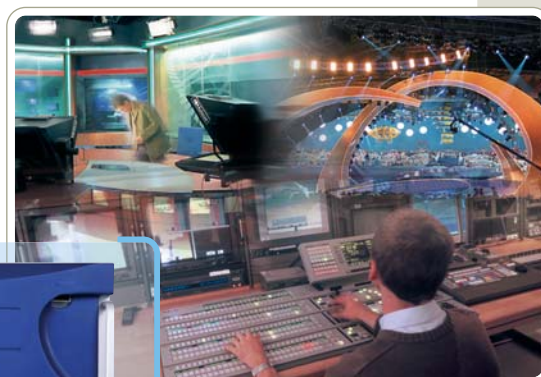

Key Features

- Field proven reliability & unmatched reactivity
- Native support for HD standards (720p, 1080i)
- Optional support for SD standards – Native MPEG IMX
- Up to 6 reversible video channels (in any input/output configuration)
- 48 audio tracks with built-in audio router
- XNet[2] 1.5 Gbps for powerful networking capabilities with instant content sharing
- High audio and video quality (up to 360 Mbps video bitrate per channel)
- Industry standard data formats and control protocols
- Comprehensive video monitoring (CVBS, SDI, HD-SDI)

XT[2]



What makes XT[2] broadcast grade

Renowned for its reliability

The core expertise at EVS consists in providing true broadcast grade platforms. The XT[2] offers perfect stability thanks to its dedicated hardware. As live production requires risk-free systems, it features hot swappable redundant power supply units. Also, because the security of video and audio is fundamental, this data remains safe thanks to RAID3 protection. Running day-in, day-out in demanding environments like Outside Broadcasts, EVS XT series servers are used in the most critical live broadcast applications worldwide.

Unmatched reactivity

Concerts, Series, Live Shows, News or Sports productions all rely on catching the finest details on the server. EVS XT[2] never stops recording so you cannot miss vital moments. Because there is no need to pre-load clips, instant play-back is one key stroke away. It offers unprecedented spooling speed without picture break-up so that individual frames can be found rapidly. These are just examples of the XT[2] instant reactivity, essential in today's fast moving productions.

XNet[2] Network

XNet[2] is an optional network consolidation solution proposed by EVS for real-time media sharing. For a true digital workflow, it is necessary for operators to share media across a network without duplicating the content. EVS' powerful XNet[2] provides a high-speed and reliable video sharing network that connects multiple XT servers together (up to 29 devices per network) to create a complete multi-channel online production network. (For example: Six XT[2] servers, each equipped with 6 channels, connected together would therefore represent a global server of 36 channels used for recording or play-out).

XNet[2] allows any video/audio source recorded by any server on the network to be available instantly to all operators, even during recording. With a sustained bandwidth of 1.5 Gb/sec., the XNet[2] ensures up to 12 high-definition (30 in SD) simultaneous channels of record/payout across the network.

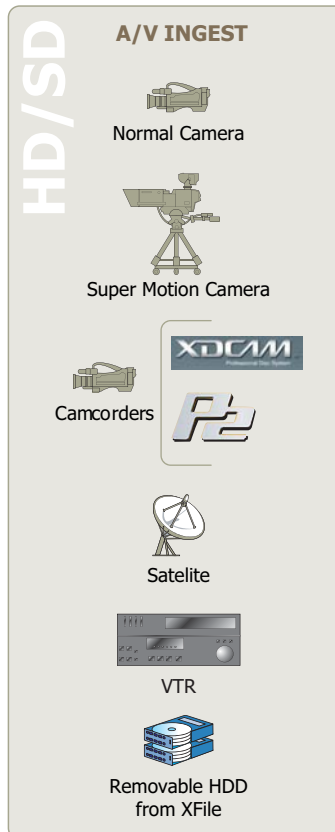

IP Director :
Content Logging & Indexing
Multi-Feed Ingest
Turn-around Editing

XT[2]

Safe-guard your investment with XT[2]

Uncompromised picture quality

Picture quality has always been one of EVS prime concerns, which equates to impressive audio and video performance. EVS superior video codecs provide quality at bitrates no other production server can reach (up to 6 HD channel at 150 Mbps, superior to the bitrate of HDCAM). The built-in professional audio processors offer 24-bit broadcast grade audio performance with essential features such as smooth scrubbing and audio splitting. The XT[2] remains the one and only server to provide HD super slow motion, increasingly popular for live sports coverage in High Definition.

The future-proof server platform

With fast-changing requirements from producers, directors and broadcasters, the XT[2] platform offers unique flexibility, key to a long-lasting investment. The audio and video ports are truly configurable: each audio and video port can be used as an input or output according to the production requirements. This becomes particularly useful in trucks with needs for multiple sources one day and maximum playback capacity the day after.

EVS offers a perfect solution to suit today's production needs and meet tomorrow's demands. With new trends in HD production, XT[2] supports all popular HD standards and switches effortlessly between NTSC and PAL, 720p and 1080i, in a matter of seconds.

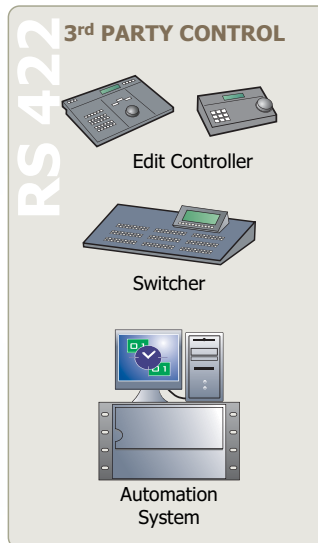
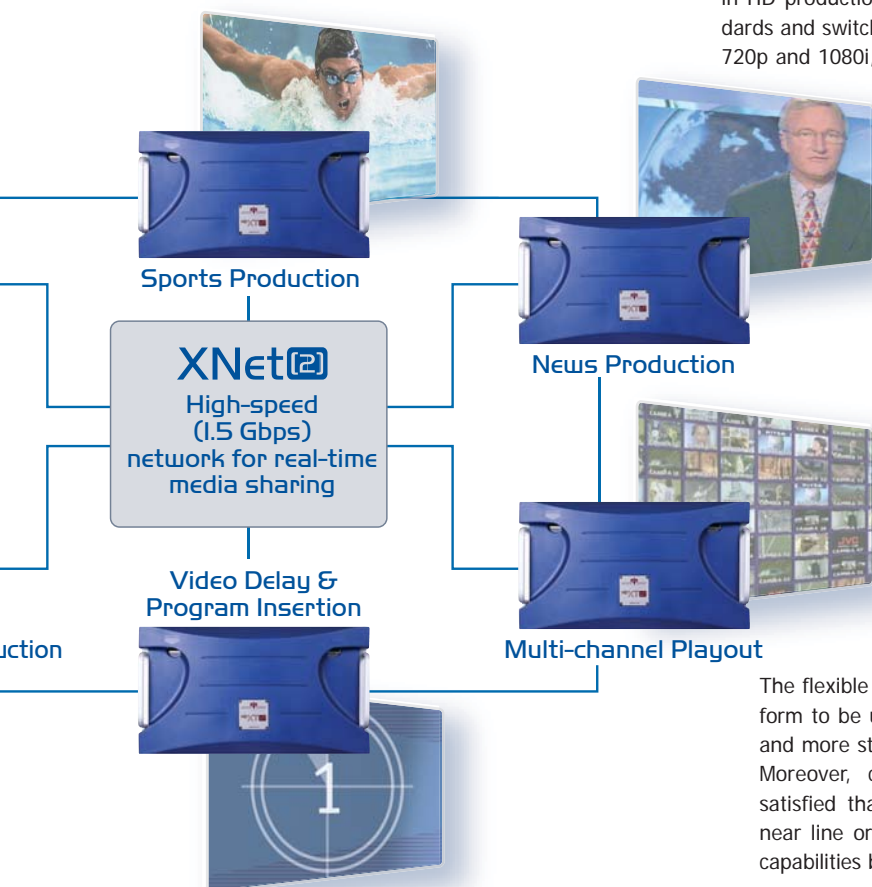

The flexible XT[2] architecture also allows the platform to be upgraded to add more inputs / outputs and more storage.

Moreover, capacity hungry applications can be satisfied thanks to its distributed storage. Should near line or offline capacity be required, archiving capabilities become endless with EVS XFile gateway.

Finally, the platform offers maximum interoperability and complete flexibility of control thanks to its comprehensive built-in remote control interfaces with automation systems, switchers and edit controllers.

EVS SOFTWARE APPLICATIONS

Muticam :
Multi-camera Recording
Live Slow Motion
Highlights Editing

AirBox - AirEdit :
Multi-channel Playout
Video Delay & Program Insertion





Specifications

Next Generation HD/SD Production Server

TECHNICAL SPECIFICATIONS	
Video System	Up to 6 in/out channels in any in/out configuration User selectable 1080i or 720p, 50 or 59.94Hz, Optional SD compatibility (NTSC and PAL)
Video Compression	HD: Intra-frame, user selectable bitrate 100-360 Mbps SD: MPEG-2, I-frame, MPEG IMX, MJPEG, user selectable bitrate 20-100 Mbps
Audio System	Up to 48 uncompressed tracks at 24-bit / 48kHz with built-in audio router Sample rate conversion from 25-55kHz to 48kHz, level adjustments Dolby-E compatible
Recording Capacity	5x internal 73GB/ 146GB/ 300GB drives in standard 6RU chassis (7h, 15h, 30h @ 100 Mbps with RAID-3 redundancy). Extended 7RU chassis: 10x300GB RAID3 (60h @ 100Mbps)
Inputs - Video Channels	Up to 6x SD/HD-SDI 1.485Gbps (SMPTE 292M), 8 or 10-bit resolution with autodetection Full frame synchronizer on each input SDI 270Mbps (SMPTE 259M) on same input (option)
Inputs - Audio	8x analog balanced (4 stereo pairs) + 8x AES/EBU (8 stereo pairs) 8x embedded tracks (4 stereo pairs) per video channel
Outputs - Video Channels	Up to 6x SD/HD-SDI 1.485Gbps (SMPTE 292M), 10-bit resolution Down-converted SDI 270Mbps (SMPTE 259M) from each channel Monitoring outputs with switchable super-imposed timecode and channel status information (per video channel): 1x HD-SDI + 1x SDI or CVBS (software switchable)
Outputs - Audio	8x analog balanced (4 stereo pairs) + 8x AES/EBU (8 stereo pairs) 8x embedded tracks (4 stereo pairs) per video channel 4x analog balanced monitoring outputs
Genlock	Analog Black & Burst or Tri-Level Sync input (with loop-through)
Timecode	LTC: 1x in and 1x out (balanced XLR) in SD: SMPTE 266M (VITC in VBI) in HD: RP188 (HANC VITC1, HANC VITC2, HANC LTC)
Network	XNet[2] 1.5Gbps in and out, XNnet 540Mbps in and out
Remote Control	6x RS-422 in 6RU, 4x RS-422 in 4RU, 2x RS-232, 12x GPI (4 in, 4 out, 4 configurable)
Control Protocols	Harris VDCP, Odetics, Sony BVW, Thomson XtenDD-35, EVS AVSP

Two Versions: 4 RU and 6 RU

	4RU	6RU
Maximum number of video channels	4 channels	6 channels
Power Supply	Single	Hot or cold swappable, redundant
Remote Control Protocols	4x RS-422, 2x RS-232	6x RS-422, 2x RS-232

Learn more about EVS solutions at www.evs.tv or contact us at :

Headquarters

EVS Broadcast Equipment

Liège Science Park
Rue Bois St-Jean, 16
4102 Liège Ougrée
Belgium

Tel : +32 4 361 70 00
Fax : +32 4 361 70 99

Sales and Support Offices

North America & Latin America

New Jersey : +1 973 575 7811 evsusa@evs.tv

Asia & Pacific

Hong Kong : +852 2914 2501 sales@evs-asia.com.hk
China : +8610 6808 0248 evschina@evs.tv

Europe, Middle East & Africa

Headquarters : +32 4 361 70 00
France : +33 1 46 99 9000
Italy : +39 030 242 71 34
UK & Ireland : +44 208 315 6551

sales@evs.tv
france@evs.tv
italy@evs.tv
uk@evs.tv

