

Assembly Instructions Stand

mc² 66

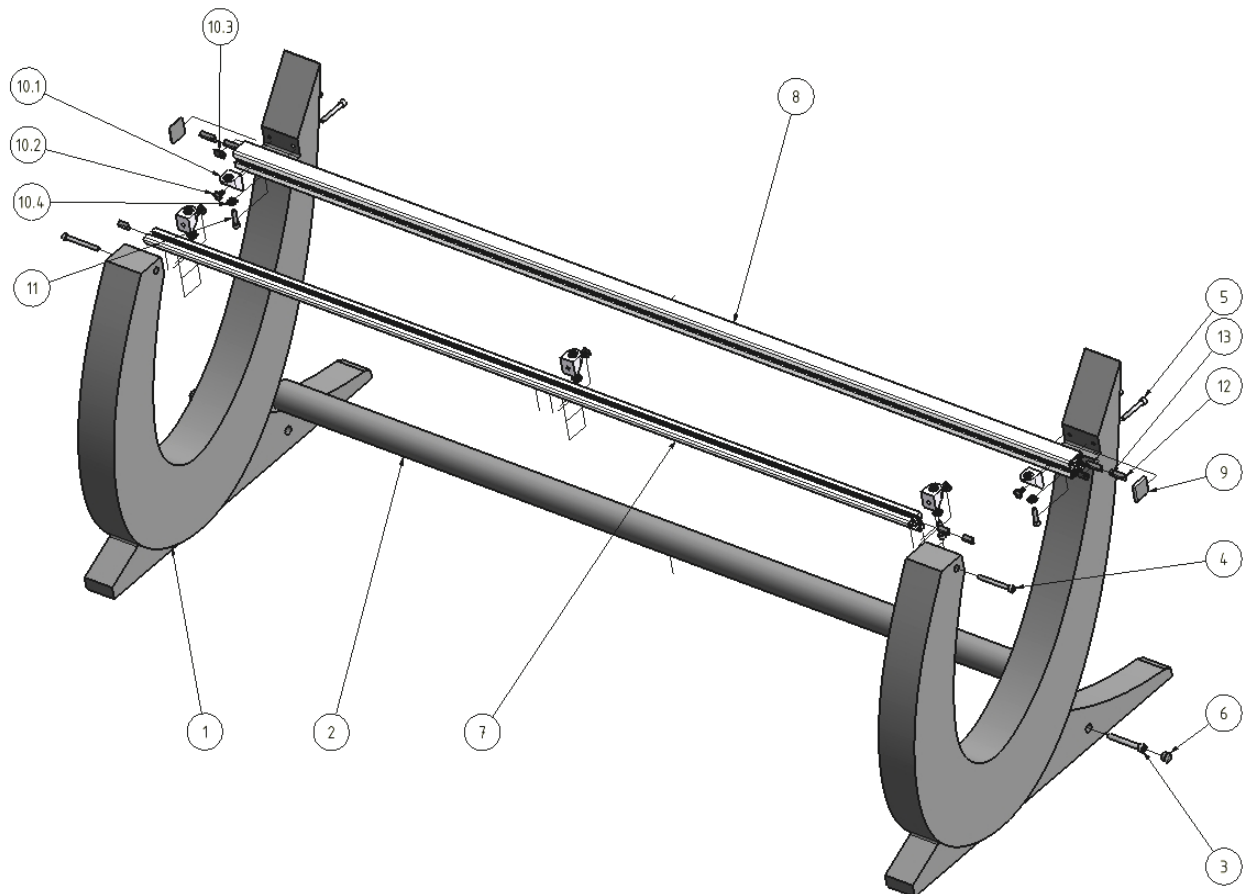

Page 1 of 3



Position	Item no	Number	Name
1	320.2268	2	stand element
2	230.22xx	1	crossbar kpl
3	300.1336	2	allen screw
4	300.1340	2	allen screw
5	300.1341	4	allen screw
6	350.0674	2	covering cap
7	320.26xx	1	triangular steel tube
8	320.26xx	1	rectangular element
9	350.8023	2	covering cap
10.1	350.8024	5	joint angle
10.2	350.8024	5	fillister head screw
10.3	350.8024	5	slot nut
10.4	350.8024	5	centring ring
11	350.1339	5	allen screw

Assembly Instructions Stand

mc² 66

Page 2 of 3

12	350.8025	4	nut screw
13	300.5013	4	set screw

1. Screw the two stand elements (pos. 1) and the crossbar together using the allen screws M10 x 80 (pos. 3)
2. Fix the covering caps (pos. 6)

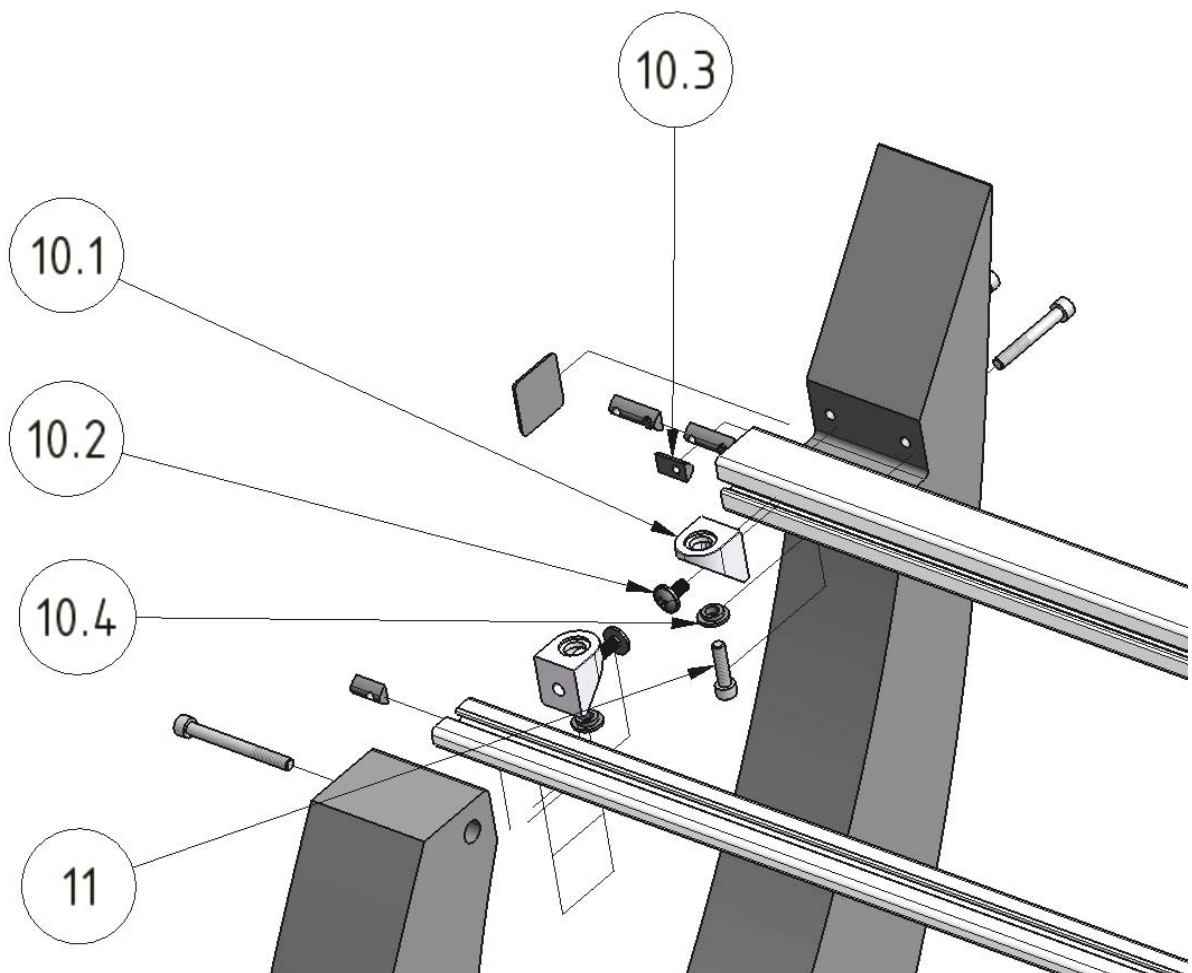

3. Insert three slot nuts (pos.10.3) in the triangular steel tube (pos. 7)
4. Mount the triangular steel tube (pos.7) with the allen screws (pos. 4) M8 x 90 to the stand elements
5. Connect three mounting angles (pos.10.1) with fillister head screw M8x18 (pos. 10.2) to the slot nut

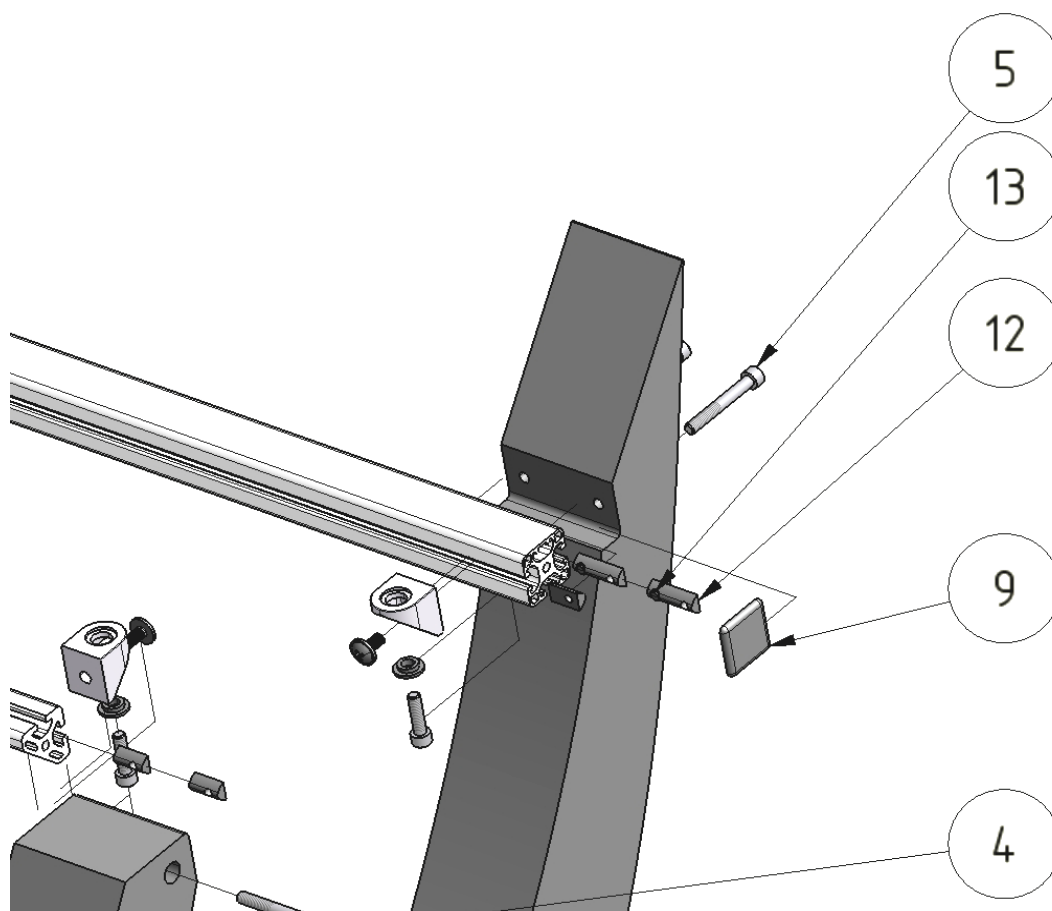

6. Screw the four set screws M8x10 (pos. 13) into the four slot nuts (pos. 12) and insert the element into the rectangular element (pos. 8), align it and fix it with the set screw at the defined position
7. Mount the triangular element (pos. 8) with allen screws (Pos.5) M8 x 60 to the leg elements on both sides
8. Insert two slot nuts (pos. 10.3) in the slot of the rectangular element
9. Press the covering cap (pos. 9) on both sides into the rectangular element
10. Connect the remaining two mounting angles (pos. 10.1) with fillister head screw M8 x 18 (pos. 10.2) to the slot nuts.
11. Position the console in centre to the completely mounted stand and align it
12. Screw the console with the five cylindric head screws M8x35 (pos. 12) and centring rings (pos 10.1) from below to the stand.