



USER GUIDE



HDMI To SD-SDI / HD-SDI / 3G-SDI

CONVERTING HDMI TO SD/HD/3G VIDEO

MODEL No.

PRO-HDMI2HD



HDMI[™]
HIGH DEFINITION MULTIMEDIA INTERFACE



MADE IN TAIWAN

Thank You.

Thank you for purchasing your new PESA video processing equipment. We appreciate your confidence in our products. PESA produces quality, state-of-the-art equipment designed to deliver our users the highest degree of performance, dependability and versatility available anywhere. We want you to know that if you ever have a concern or problem with a PESA product, we have a team of engineers, technicians and customer service professionals available 24/7/365 to help resolve the issue.

Our commitment is to continue earning the trust and confidence of our customers throughout the industry by incorporating cutting-edge technology into the highest quality, most cost effective products on the market. And we would like to invite you to tell us how we're doing. If you have any comments or suggestions concerning your PESA equipment, please contact our Customer Service Department.

SALES, SERVICE AND ORDERING ASSISTANCE

PESA

103 Quality Circle, Suite 210

Huntsville AL 35806 USA

www.pesa.com

MAIN OFFICE

Tel: 256.726.9200

Fax: 256.726.9271

EMAIL: SALESTEAM@PESA.COM

SERVICE DEPARTMENT

Tel: 256.726.9222 (24/7)

Toll Free: 800.323.7372

Fax: 256.726.9268

EMAIL : service@pesa.com

© 2012 PESA, All Rights Reserved.

Cougar is a trademark of PESA Switching Systems in the United States and/or other countries.

Microsoft, Windows, and Windows NT are either registered trademarks or trademarks of Microsoft Corporation in the United States and/or other countries.

No part of this publication (including text, illustrations, tables, and charts) may be reproduced, stored in any retrieval system, or transmitted in any form or by any means, including but not limited to electronic, mechanical, photocopying, recording or otherwise, without the prior written permission of PESA.

All information, illustrations, and specifications contained in this publication are based on the latest product information available at the time of publication approval. The right is reserved to make changes at any time without notice.

Printed in the United States of America.

IMPORTANT SAFETY INSTRUCTIONS

1. Read, keep, and follow these instructions.
2. Heed all warnings.
3. Installation and servicing should only be done by qualified service personnel and conform to all local codes.

WARNING:

1. To reduce the risk of fire or electric shock, do not expose this unit to rain or moisture.
2. This unit is designed for indoor use only and it must not be installed where exposed to rain or moisture.
3. Do not expose this unit to dripping or splashing. Do not place objects filled with liquids, such as vases, on this unit.
4. Do not block any ventilation openings. Install in accordance with the manufacturer's instructions.
5. Do not install near any heat source.
6. Only use attachments/accessories specified by the manufacturer.
7. Clean only with dry cloth.
8. Do not defeat the safety purpose of the polarized or grounding-type plug.
9. Protect the power cord from being walked on or pinched, particularly at plugs, convenience receptacles, and the point where they exit from the unit.

SERVICE INFORMATION (QUALIFIED PERSONNEL ONLY):

1. Please thoroughly familiarize yourself with the information in this manual prior to installation and operation.
2. Only use replacement parts recommended by PESA.
3. After replacement/repair of this unit's electrical components, conduct a resistance measurement between line and exposed parts to verify the exposed parts have not been connected to line circuitry.

LIMITATION OF LIABILITY

All information, illustrations, and specifications contained in this publication are based on the latest product information available at the time of publication approval. The right is reserved to make changes at any time without notice.

DISCLAIMER OF WARRANTY

IN NO EVENT SHALL PESA SWITCHING SYSTEMS, INC. BE LIABLE FOR ANY PARTY OR ANY PERSON, EXCEPT FOR CERTAIN WARRANTY PROGRAM OFFERED BY THE LOCAL DEALER OF PESA, FOR THE CASES BUT NOT LIMITED TO THE BELOW:

1. ANY DAMAGE OR LOSS, INCLUDING WITHOUT LIMITATION, DIRECT OR INDIRECT, SPECIAL CONSEQUENTIAL OR EXEMPLARY, ARISING OUT OF OR RELATING TO THE PRODUCT.
2. PERSONAL INJURY OR ANY DAMAGE CAUSED BY INAPPROPRIATE USE OF NEGLIGENT OPERATION OF THE USER.
3. UNAUTHORIZED DISASSEMBLY, REPAIR OR MODIFICATION OF THE PRODUCT BY THE USER.
4. INCONVENIENCE OR ANY LOSS ARISING WHEN IMAGES ARE NOT DISPLAYED, DUE TO ANY REASON OR CAUSE INCLUDING ANY FAILURE OR PROBLEM OF THE PRODUCT.
5. ANY PROBLEM, CONSEQUENTIAL INCONVENIENCE OR LOSS OR DAMAGE, ARISING OUT OF THE SYSTEM COMBINED BY THE DEVICES OF THIRD PARTY.

TRADEMARKS AND REGISTERED TRADEMARKS

- MICROSOFT, WINDOWS, WINDOWS XP, WINDOWS 7, WINDOWS VISTA, WINDOWS EXPLORER ARE REGISTERED TRADEMARKS OF MICROSOFT CORPORATION IN THE U.S. AND/OR OTHER COUNTRIES
- OTHER COMPANY NAMES AND PRODUCT NAMES APPEARING IN THIS DOCUMENT ARE REGISTERED TRADEMARKS OR TRADEMARKS OF THE COMPANY CONCERNED.

ORDER INFORMATION - HDMI CONVERTER

The **PRO-HDMI2HD** is a module for converting HDMI to 3G/HD/SD-SDI in real time. The conversion between HDMI and SDI is pure digital and guarantees zero-loss transformation for both audio and video. Plus, with up to 8 channels audio support, 7.1 channel or 5.1 channel audio becomes available. The HDMI2HD provides two low jitter SDI outputs for daisy chain or for connecting multiple monitors.

FEATURES

- Input support for HDMI Deep Color
- Support for HDCP
- Output support for 3G-SDI formats(SMPTE 425M, Level A): 1080p @50/59.94/60Hz (4:2:2)
- Output support for high-definition (HD-SDI) formats: 1080i @50/59.94/60Hz, 720p @50/59.94/60Hz
- Output support for standard-definition (SD-SDI) formats: NTSC @59.94Hz, PAL @50Hz
- Bit Rates for 2.97 Gbps, 2.967Gbps, 1.485 Gbps, 1.4835 Gbps, 270 Mbps
- Auto 3G/HD/SD-SDI detection
- Easy installation with wall mounting design
- Supports up to 8 channels of audio, 7.1 or 5.1 optional
- Low jitter
- Re-clocked outputs for looping SD/HD/3G SDI signals

Part number	Description
PRO-HDMI2HD	Conversion module to convert HDMI to SD-SDI, HD-SDI, and 3G-SDI

TABLE OF CONTENTS

CHAPTER 1	ABOUT YOUR PRO-HDMI2HD PRODUCT	1-1
1.1	DESCRIPTION.....	1-1
1.2	CONNECTING INPUTS.....	1-1
1.3	CONNECTING OUTPUTS FOR SD, HD, 3G FORMATS.....	1-2
1.4	CONNECTING POWER TO THE PRO-HDMI2HD	1-2
CHAPTER 2	INSTALLING YOUR PRO-HDMI2HD	2-1
2.1	SUPPORTED RESOLUTIONS.....	2-1
2.2	CABLE LENGTHS – MAXIMUM DISTANCES AND CONNECTION TYPE	2-2
2.3	DIP SWITCH SETTINGS – SETTING DIP SWITCH SETTING FOR AUDIO AND EDID LEARNING.....	2-2
CHAPTER 3	MAINTENANCE AND REPAIR	3-1
3.1	PERIODIC MAINTENANCE	3-1
3.2	PESA CUSTOMER SERVICE.....	3-1
3.3	REPAIR	3-1
3.4	REPLACEMENT PARTS	3-1
3.5	FACTORY SERVICE	3-1
CHAPTER 4	SPECIFICATIONS.....	4-1
CHAPTER 5	WARRANTY.....	5-1

LIST OF FIGURES

FIGURE 1-1: PESA PRO-HDMI2HD MODULE	1-1
FIGURE 1-2 : PESA PRO-HDMI2HD INPUT CONNECTIONS IN HDMI TYPE-A STYLE.....	1-1
FIGURE 1-3 : PESA PRO-HDMI2HD ALLOWS UP TO TWO RE-CLOCKED OUTPUTS FOR SMPTE 259, 292, 424.....	1-2
FIGURE 1-4: PESA PRO-HDMI2HD POWER SUPPLY CONNECTION	1-2
FIGURE 2-1: PESA PRO-HDMI2HD FULL CONNECTION DETAIL	2-1
FIGURE 2-2: PESA PRO-HDMI2HD CABLE CONNECTIONS AND MAXIMUM LENGTHS.....	2-2
FIGURE 2-3: EDID SWITCH SETTINGS	2-2

Chapter 1 ABOUT YOUR PRO-HDMI2HD PRODUCT

1.1 DESCRIPTION

PESA's PRO-HDMI2HD is a throw-down style converter module allowing HDMI in 480p, 720p, or 1080p to SD-SDI, HD-SDI, or 3G-SDI video signals to be viewed or recorded to a professional broadcast device supporting SMPTE 259, 292, or 424. The supplied power brick accepts a primary power input of 100-240V, 50/60Hz, and supplies a +5V DC output. Power consumption is less than 3 watts.

Each PRO-HDMI2HD module sends output signals through a standard 75 Ohm BNC connection. Destination devices can be located up to 300m (1000ft) for SD-SDI, up to 150m (500ft) for HD-SDI, and 90m (300ft) for 3G-SDI.

The compact package comes with two mounting tabs for easy attachment to wall or under-the-table locations.



FIGURE 1-1: PESA PRO-HDMI2HD Module

1.2 CONNECTING INPUTS

Each PRO-HDMI2HD supports one HDMI input from a DVD player or computer. The input allows for an HDMI Type A connector (19 pin).

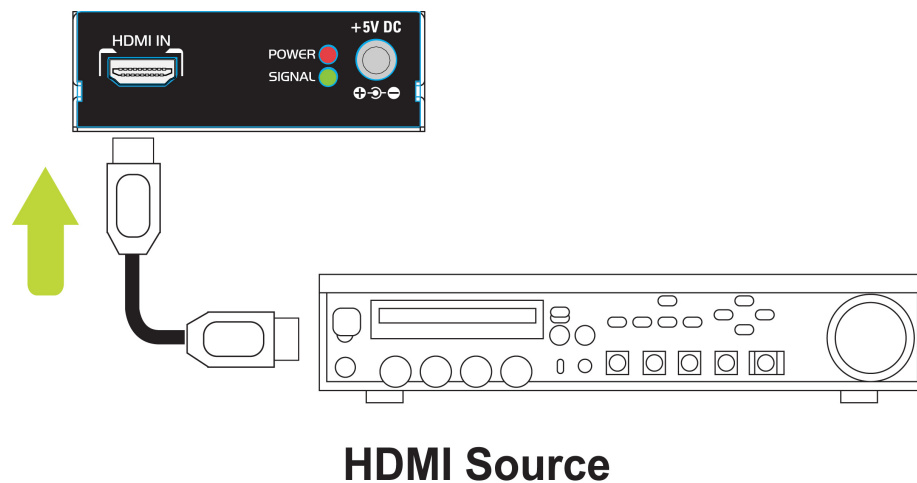

FIGURE 1-2 : PESA PRO-HDMI2HD Input Connections in HDMI Type-A Style

1.3 CONNECTING OUTPUTS FOR SD, HD, 3G FORMATS

Each PRO-HDMI2HD allows one 75 Ohm input supporting SD/HD/3G inputs. Devices can be connected up to 300m (SD-SDI), 150m (HD-SDI), and 90m (3G-SDI).

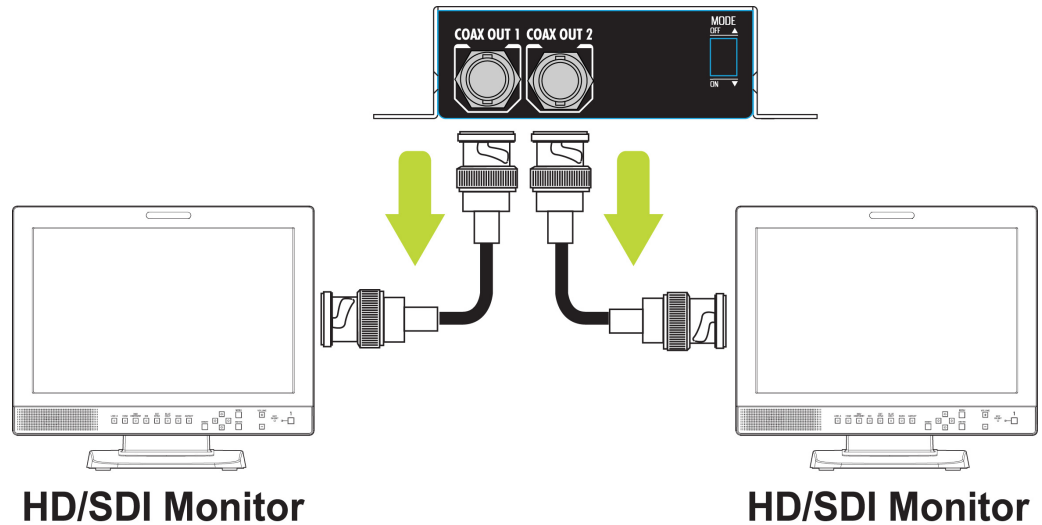

FIGURE 1-3 : PESA PRO-HDMI2HD Allows up to Two Re-clocked Outputs for SMPTE 259, 292, 424

1.4 CONNECTING POWER TO THE PRO-HDMI2HD

Connect the supplied power pack to the +5VDC connection on the module. Once power is applied, the RED power led should be lit. Once a signal has been detected, the GREEN led will be lit. Hand tighten the screw-lock to get a snug connection. DO NOT OVER TIGHTEN.

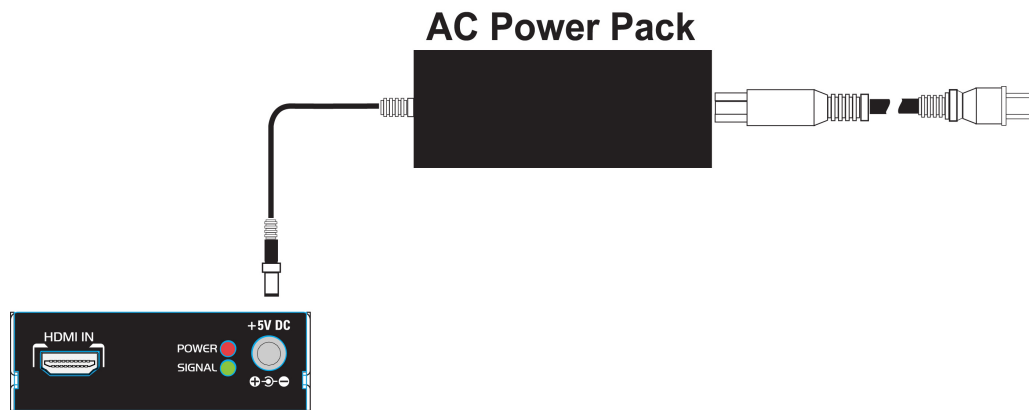

FIGURE 1-4: PESA PRO-HDMI2HD Power Supply Connection

Chapter 2 Installing your PRO-HDMI2HD

With all input and output devices and power connected, the following diagram provides a typical full detail of module installation. There are not software, but a two pin dip switch is included for special EDID settings.

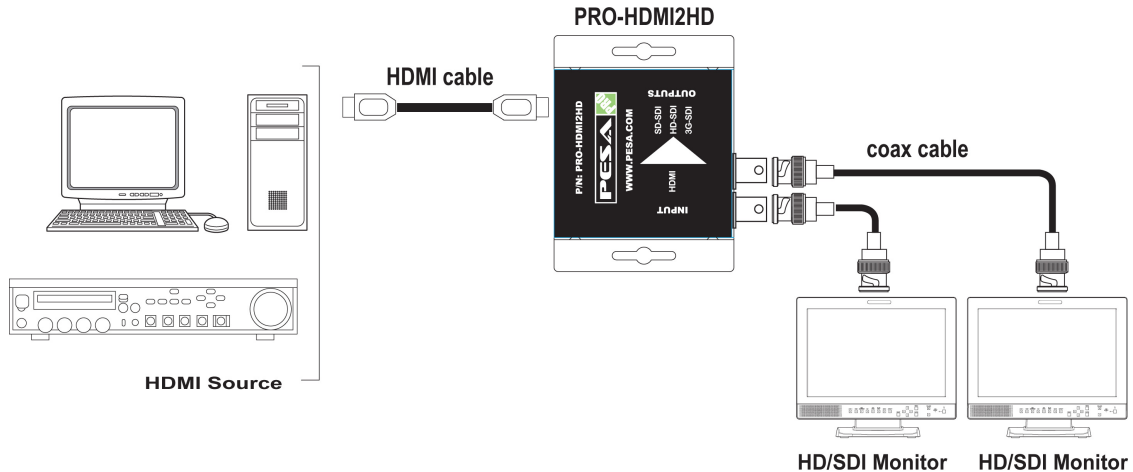

FIGURE 2-1: PESA PRO-HDMI2HD Full Connection Detail

2.1 SUPPORTED RESOLUTIONS

3G-SDI INPUTS	
1080p@ 50 / 59.94 / 60Hz	SMPTE 424 / 425 (4:2:2)
HD-SDI INPUTS	
720p @ 50Hz	SMPTE 296 -3
720p @ 59.94 / 60Hz	SMPTE 296 -1, -2
1080i @ 25Hz	SMPTE 274 -6
1080i @ 29.97 / 30Hz	SMPTE 274 -4, -5
1080p @ 23.98 / 24Hz	SMPTE 274 -10, -11
1080p @ 25Hz	SMPTE 274 -9
1080p @ 29.97 / 30Hz	SMPTE 274 -7, -8
SD-SDI INPUTS	
480i @ 29.97 / 30Hz	NTSC
576i @ 25Hz	PAL B, D, G,H, I

2.2 CABLE LENGTHS – MAXIMUM DISTANCES AND CONNECTION TYPE

Defining the types of signals and connection styles

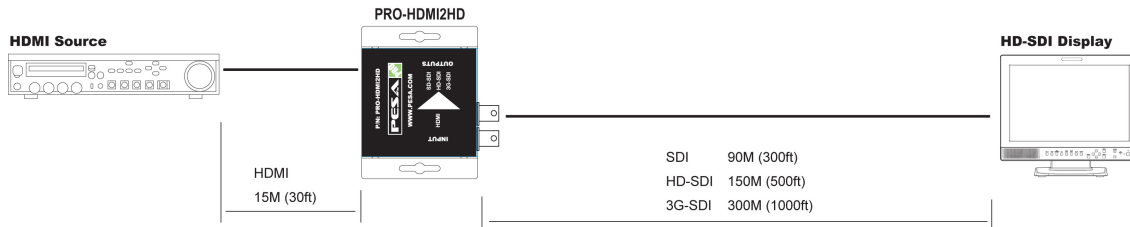

FIGURE 2-2: PESA PRO-HDMI2HD Cable Connections and Maximum Lengths

2.3 DIP SWITCH SETTINGS – SETTING DIP SWITCH SETTING FOR AUDIO AND EDID LEARNING

Each PRO-HDMI2HD comes with a two pin dip switch allowing special EDID settings for specific audio support and EDID learning.



PIN #1	PIN #2	EDID Feature
OFF ▲	OFF ▲	SD/HD/3G with multi-channel audio except DTS-HD & Dolby True HD
ON ▼	OFF ▲	SD/HD with stereo PCM audio
OFF ▲	ON ▼	SD/HD/3G with stereo PCM audio
ON ▼	ON ▼	EDID learning mode

FIGURE 2-3: EDID Switch Settings

EDID Learning Sequence

- Set PIN #1 and PIN #2 DIP Switch to ON/ON
- Connect an HDMI device to the HDMI port
- Power on the PRO-HDMI2HD module
- The RED led light will illuminate indicating the EDID learning process is complete
- Connect SD/HD/3G coax cables to the output sources
- **NOTE: DO NOT CHANGE SWITCH SETTINGS. OTHERWISE EDID INFORMATION WILL BE LOST.**

Chapter 3 Maintenance and Repair

3.1 PERIODIC MAINTENANCE

No periodic maintenance is required.

3.2 PESA CUSTOMER SERVICE

If you are experiencing any difficulty with your PRO-HD2HDMI product, please contact PESA's Customer Service Department. Skilled technicians are available to assist you 24 hours a day, every day of the year.

3.3 REPAIR

Before attempting to repair this equipment, please consult your warranty documents and PESA's Customer Service Department. Unauthorized repairs may void your warranty.

	<p>PC boards in this equipment contain Surface Mount Technology (SMT) components. Special tools and skills are required to replace these components without causing damage to adjacent areas.</p> <p>Failure to consult with Customer Service before attempting to repair these boards may void your warranty.</p>
---	--

3.4 REPLACEMENT PARTS

Only parts of the highest quality are used in the design and manufacture of this equipment. If the inherent stability and reliability are to be maintained, replacement parts must be of the same high quality. Please consult our Customer Service Department before installing any parts not purchased from PESA.

3.5 FACTORY SERVICE

Before returning any equipment to PESA for service or repair, please contact our Customer Service Department for an RMA number.

Chapter 4 Specifications

OUTPUT (SMPTE)	
Number of Outputs	2
Connector Type	BNC, 75 Ohm
Standards	SMPTE 259, 292, 424
Video Bandwidth	2.97 Gbps , 2.970/1.001 Gbps
Auto detect	Yes
Video Support	[3G] 1080p50/59.94/60 – 4:2:2 [HD] 720p50/59.94/60 [HD] 1080i 50/59.94/60 [HD] 1080p24/30 [SD] NTSC @59.94 and PAL @ 50Hz
Reclocking	[3G-SDI] up to 90m (300ft) [HD-SDI] up to 150m (500ft) [SD-SDI] up to 300m (1000ft)
Audio Support	Yes, embedded
INPUTS (HDMI)	
Number of Outputs	1
Connector Type	HDMI, Type A (19 pin female)
Standards	HDMI 1.4
Cable connection distance	15m
ENVIRONMENTAL	
Housing Dimensions	79mm x 84mm x 27mm 3.1 x 3.3 x 1.2 inches
Weight	250g (8.8 oz)
Operational Temperature	0-40 degree C
Operational Humidity	20-90% RH (non-condensation)
Power Connection	+5VDC (inter-locking power plug)
Power Consumption	3W (max)
AC Power Brick	100-240VAC, 50/60Hz

Chapter 5 Warranty

PESA Switching Systems, Inc., (PESA) warrants this equipment against defective workmanship or materials for a period of one (1) year from date of shipment. The sole warranty responsibility of PESA, shall be to replace or repair product proved to be defective. During the warranty period, defective parts will be replaced at no charge. Labor to repair or replace defective parts covered under the warranty will be performed at no charge at PESA. This warranty covers only products manufactured by PESA, and the components used in their manufacture. The warranty on assembled products sold by PESA., but manufactured by others shall be that of the original manufacturer. This warranty does not include shipping damage or damage caused by abuse, neglect, tampering by unauthorized personnel, damage inadvertently caused by the user, preventative maintenance, or any equipment or part thereof whose serial number has been removed or defaced. Neither the seller nor the manufacturer shall be liable for any injury, loss or damage, direct or consequential, arising out of the inability to use the product. Before using, user shall determine the suitability of the product for the intended use, and user assumes all risk and liability whatsoever in connection therewith. This warranty is effective only at the PESA factory in Huntsville, Alabama, USA. If possible, retain the original packing material for use in the unlikely event that your equipment must be returned to the PESA factory. When shipping your equipment, the shipping charges must be prepaid. The repaired unit will be returned to you, freight prepaid. This warranty is exclusive and in lieu of all other warranties, whether expressed or implied, including the implied warranties of merchantability and fitness for a particular purpose.



PESA