

[Confidential]

Sony Corporation

No. SWEM16-008

Technical Memo

Class [3]

Issued : April 19, 2016

Subject: Service Part Registration [Cap Pull Tool]

[Applicable Model]

Model / Destination	Serial Number	Number of Unit
ICP-3000 CNB	ALL	
ICP-3000 SYL	ALL	
ICP-3016 CNB	ALL	
ICP-3016 SYL	ALL	
ICP-6520 CNB	ALL	
ICP-6520 SYL	ALL	
ICP-6530 CNB	ALL	
ICP-6530 SYL	ALL	
ICP-X7000	ALL	
PWSK-4403 SYM	ALL	

[Description]

To improve the operability and the durability, the cap pull tool as described below is changed.

[Part Registration Info.]

Part Name	Part No.
TOOL, KEYTOP PULL	4-592-036-01

The above part will be supplied with the video switcher control panel ICP series and ICP-X series, and it is also supplied as the service part.

In the diagrams below, the tool is described as cap pull tool.

[How to use]

How to use new tool is described below.

As for the PWSK-4403(SY), procedrue 2) and 3) are not necessary.

1) Removal of the cap and the diffusion plate (without switch guard)

- Hook the cap pull tool to pull out the key-top to the two grooves of the cap/diffusion plate.
- Hold and push portion A (two locations) near the end of the cap pull tool in the direction of arrow B, and pull out the cap/diffusion plate.

Note:

As shown in the right diagram, pull them by holding the lower portion of the tool as much as possible.

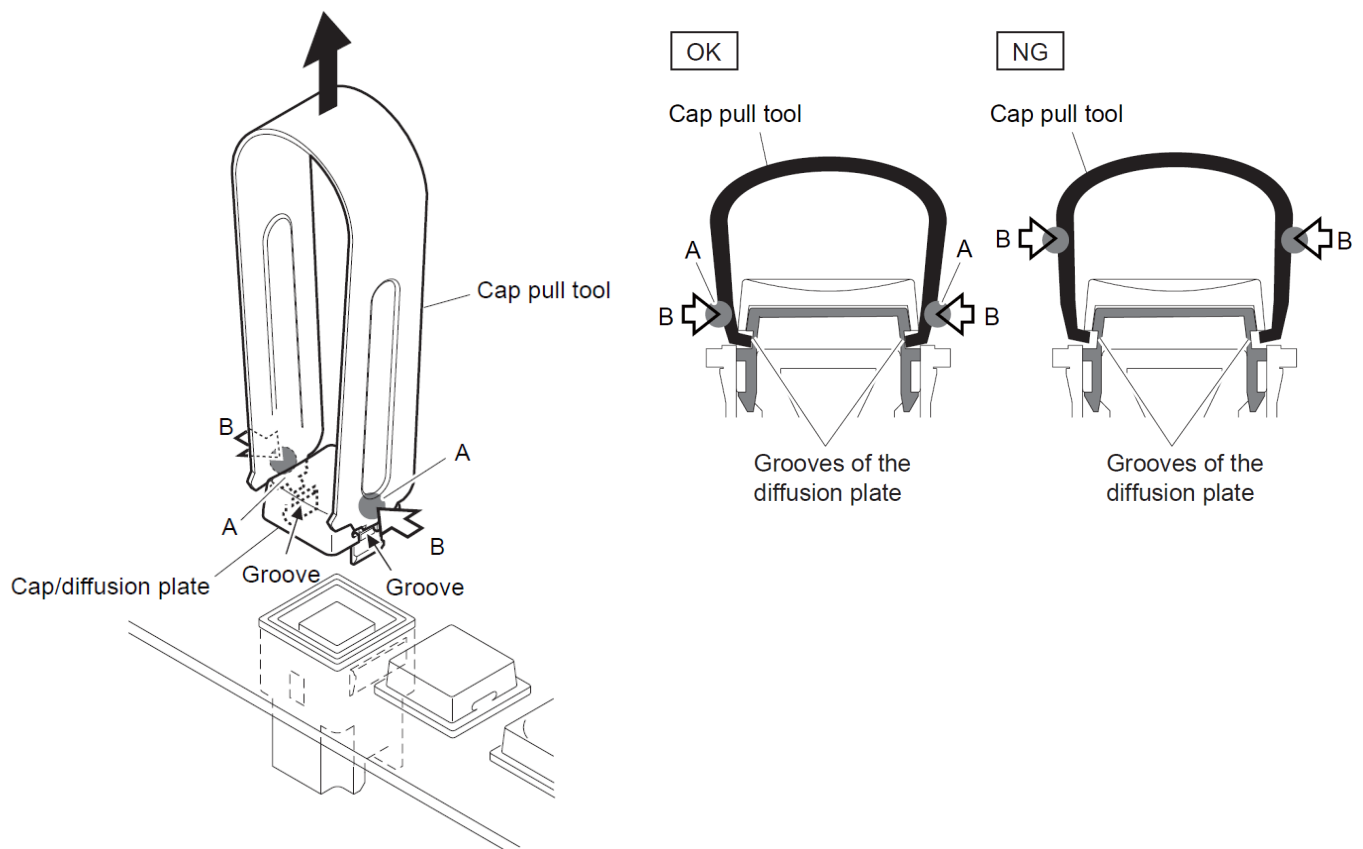

2) Removal of the cap and the diffusion plate (with switch guard)

- Insert the projection of the cap pull tool into the groove of the cap/diffusion plate.
- Turn the cap pull tool in the direction of arrow and lift one side of the cap/diffusion plate to remove it as shown in the figure below.

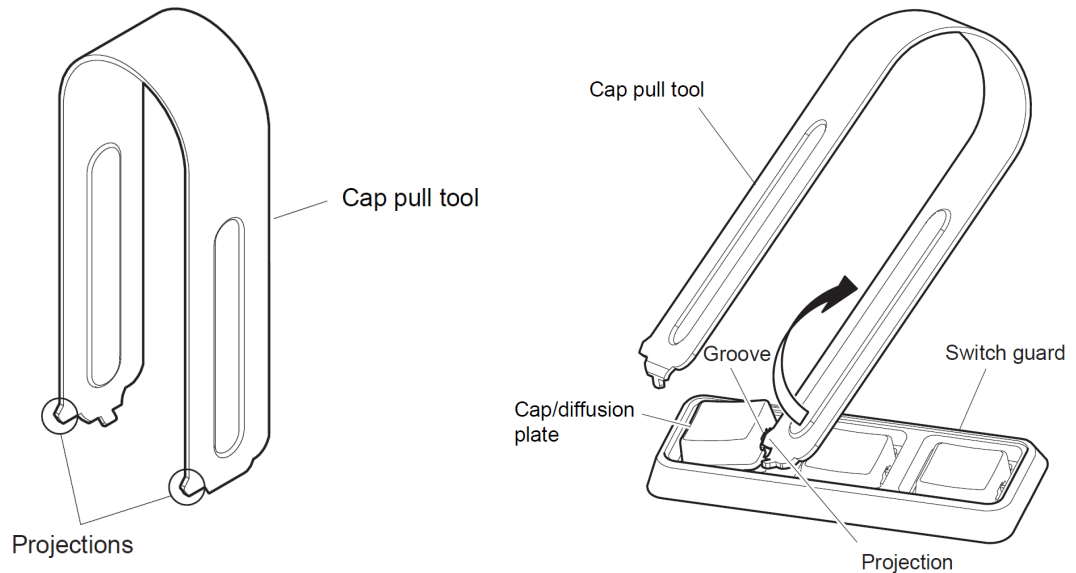

3) Removal of the switch cover

- Hook the cap pull tool to pull out the key-top to the two grooves of the switch cover.

Note: Pull the cover after confirming if the projections of the tool are inserted to the groove surely.

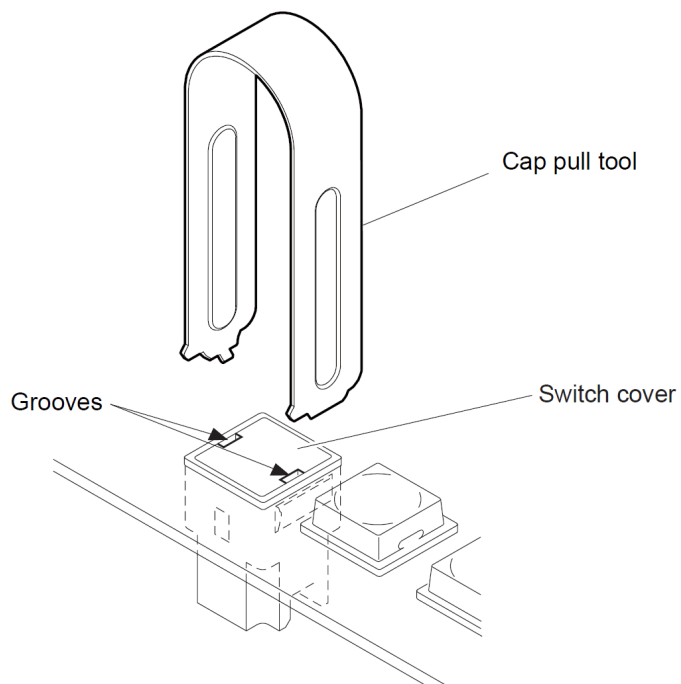

4) Separation of the cap and the diffusion plate

- Remove the cap/diffusion plate.
- Insert one end of the cap pull tool into one groove of the removed cap/diffusion plate.
- Push the end of the cap pull tool against the wall in front of the other groove.
- In this state, push the end of the cap pull tool in the direction of arrow A and draw the diffusion plate in the direction of arrow B to remove it.

